

CEI IS ASSISTING CURRENT AND SPECULATIVE LANDOWNERS, AS WELL AS REAL ESTATE PROFESSIONALS, WITH PROPERTY ACQUISITION AND PLANNING DECISIONS THROUGH THE USE OF ENVIRONMENTAL MAPPING AND DATA COMPILATION SERVICES.

Using CEI's easy to use and efficient online proposal request form, anyone can acquire, for properties of interest, relevant information that is important for decision-making but often not easily obtainable by the typical owner or investor. The request form is on the **REAL ESTATE CONSULTING** link at:

www.coastalenv.com

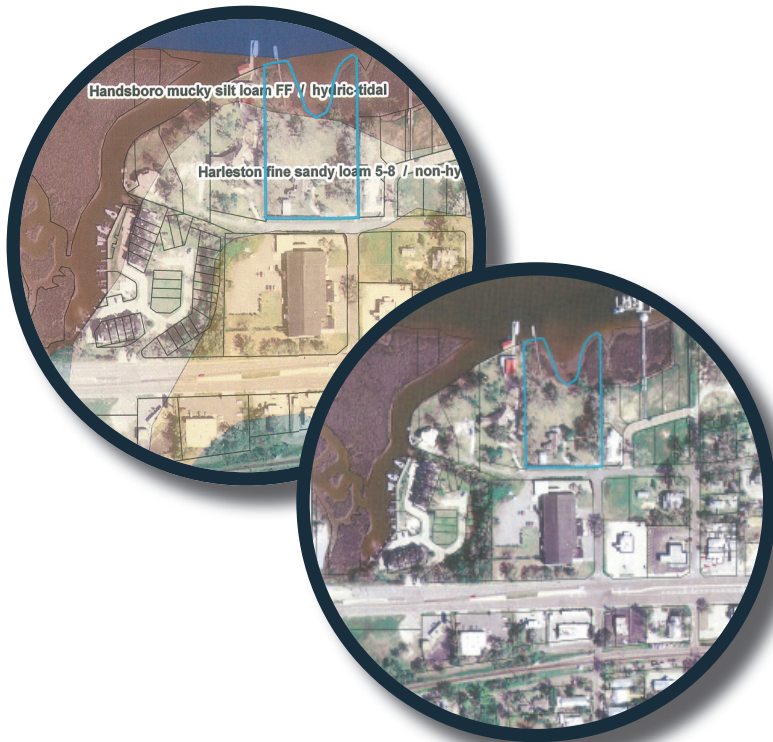

Standard Map Package:

- Most recent aerial photography
- USDA soil survey data and hydric classifications
- USGS 7.5-min. topographic quad maps

Comprehensive Map Package Options:

- Daily traffic counts of nearby streets and intersections
- Competition maps showing neighboring commercial or business locations
- Updated FEMA flood maps
- Storm surge inundation from Hurricane Katrina
- Historical aerial photographs
- Demographic/Census/Income Data

All maps and data can be provided in hardcopy or digital format (.pdf, .jpg or .tif) to facilitate duplication for marketing and sales.

WHO CAN BENEFIT?

- Land Developers
- Site and Regional Planners
- Private Landowners
- Real Estate Investors
- Real Estate Brokers and Agents
- Economic Development Entities
- Municipalities

WHAT ARE THE BENEFITS OF USING REAL ESTATE CONSULTING SERVICES?

- Smart Growth Principles
- Real Estate Marketing
- Green Practices
- Preliminary CAD design for residential or commercial focus
- Identification of property potential uses and environmental constraints
- Identification of regulatory compliance issues



CEI's GOAL IS TO PROVIDE RELIABLE EXPERTISE TO LANDOWNERS, DEVELOPERS AND REAL ESTATE AGENTS FOR USE IN CONSULTING AND MARKETING, QUICKLY AND AT A REASONABLE COST.

COASTAL ENVIRONMENTS, INC. (CEI), has provided environmental services for the Gulf South region in the areas of applied science, planning and cultural resources since 1972. The Real Estate Consulting Services Division is a comprehensive consulting and marketing service that assists real estate brokers and agents, developers, investors and planners, as well as the individual landowners in obtaining site specific knowledge about properties of interest that can help guide marketing and acquisition decisions.

Clients are assisted in identifying and realizing opportunities for economic development in concert with environmental and regulatory requirements and constraints.

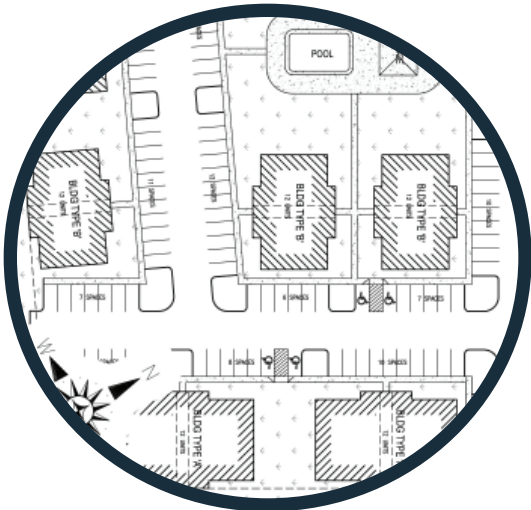

Coastal Environments, Inc.
812 Water Street • Biloxi, MS 39530
228-385-5547 (Ph) • 228-385-5548 (Fx)
www.coastalenv.com

DOCUMENTING THE PAST
INVESTIGATING THE PRESENT
PLANNING FOR THE FUTURE

COASTAL ENVIRONMENTS, INC.

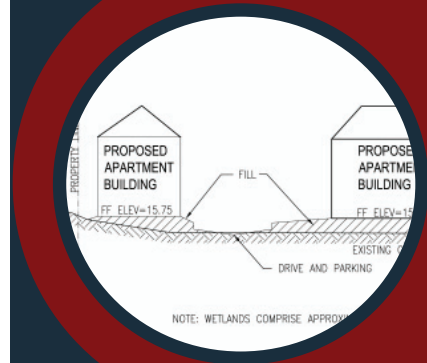

R
E
A
L

E
S
T
A
T
E

CONSULTING
SERVICES